

In a class by itself

Finally, a heavy-duty horizontal band saw for all your resawing applications, including flooring, windows, doors, furniture and musical instruments, etc.

Unlike other resaws, the REMAX 500 is built from solid cast iron, and incorporates a durable and effective guiding system and thin-kerf saw blades under high tension. The machine produces a smooth, glueable surface with superior tolerances.

The REMAX 500's modular construction gives your company room to grow. A single, standalone unit can be purchased initially; additional units can then be added in line as production requirements demand.

Detailed features

- Blade cutting speed infinitely variable depending upon type of wood and feed speed
- Infinitely adjustable saw blade tensioning
- Cast iron main frame offers sturdy construction for minimal machine vibration during production
- Air-loaded hold-down shoes prevent movement of lumber during cutting
- CNC touch-screen control panel for easy height adjustment of one or multiple heads
- Modular system can be purchased with a single sawing unit or multiple sawing units that are controlled via a central touchscreen

HORIZONTAL CNC RE-SAW

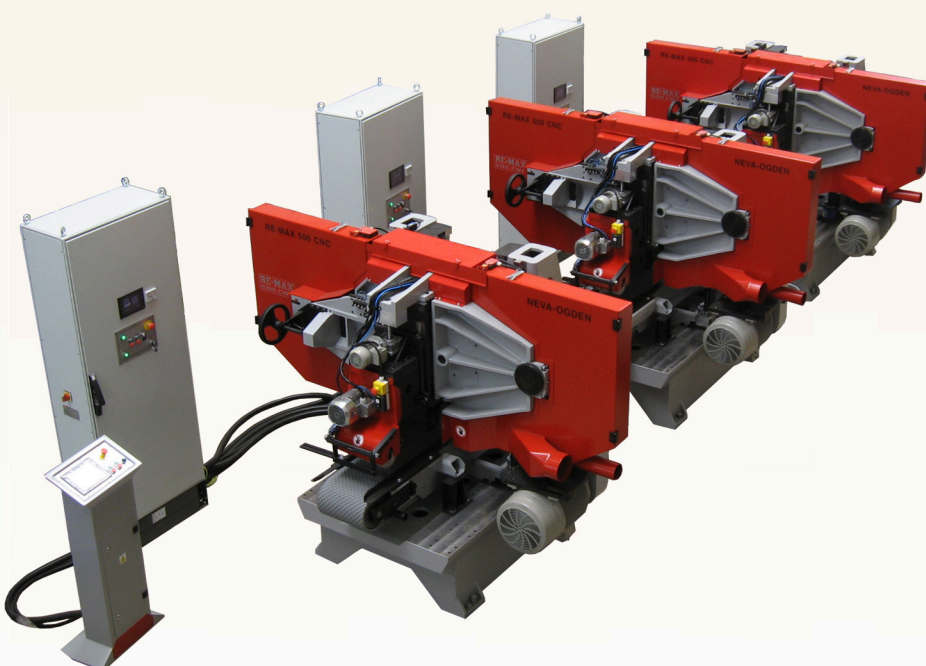

Put these advantages to work in your operation

- Heavy-duty, cast-iron construction – built for longevity and superior tolerances
- Thin-kerf, high-tension blades to minimize your waste
- Produces smooth, glueable surface
- Handles material to 500 mm (15") wide, 150 mm (6") thick
- Variable feed 5 – 60 m/min (15 – 200 fpm)

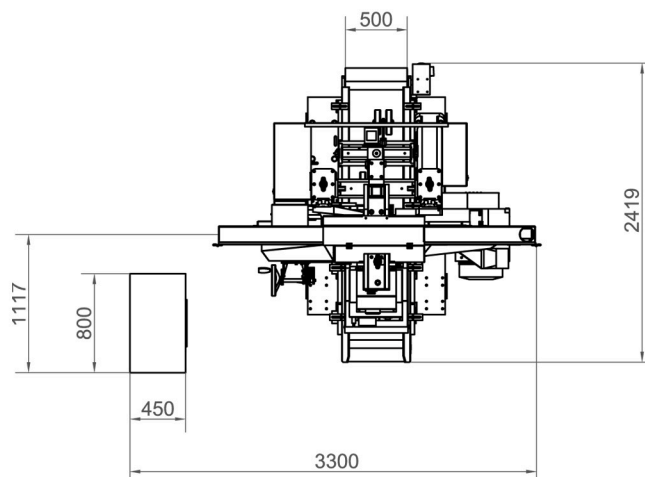
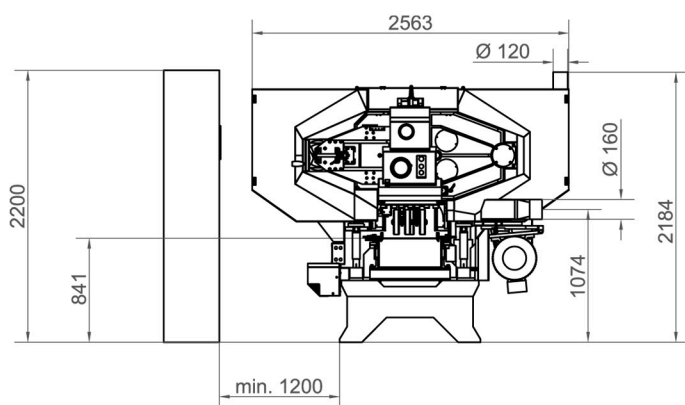

TECHNICAL SPECIFICATIONS

Machine voltage (standard)	3x 400 V, 50Hz
Main motor	22 kW (30 hp)
Cutting speed – adjustable up to	50 m/s.
Feed speed – adjustable up to	16 m/min.
Pulley diameter	1000 mm
Cutting width	330 / 500 mm
Maximum thickness (height) of wood	150 mm
Minimum board length	800 mm
Minimum slat thickness, according to slat width	2 mm
Dust hood	Ø 160 mm
Dust hood	Ø 120 mm
Air speed	30 m/s
Compressed air minimum	6 bar
Compressed air volume	2 - 10 m³/h

MACHINE DIMENSIONS

Width	2700 mm
Length	2300 mm
Height	2200 mm
Weight	4500 kg

BAND SAW BLADES

Recommended body thickness	0.7 to 1.0 mm
Recommended width	75 to 90 mm
Recommended length	6170 mm
Minimum length	6160 mm
Maximum length	6230 mm
Saw kerf (depends on tools & application)	1,1 mm – 1,8 mm

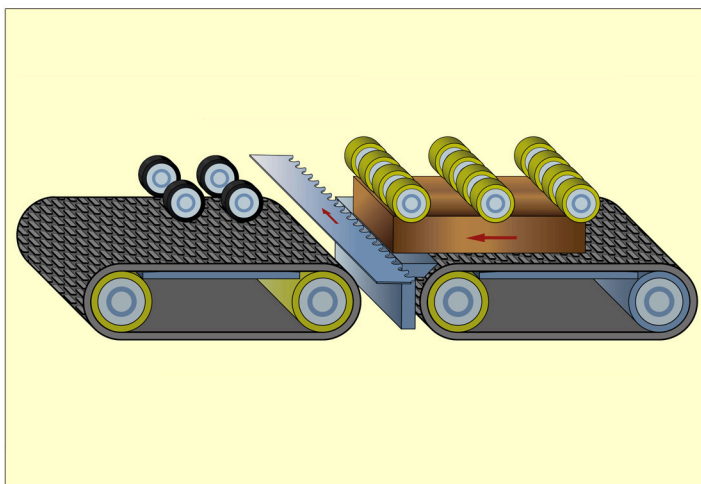
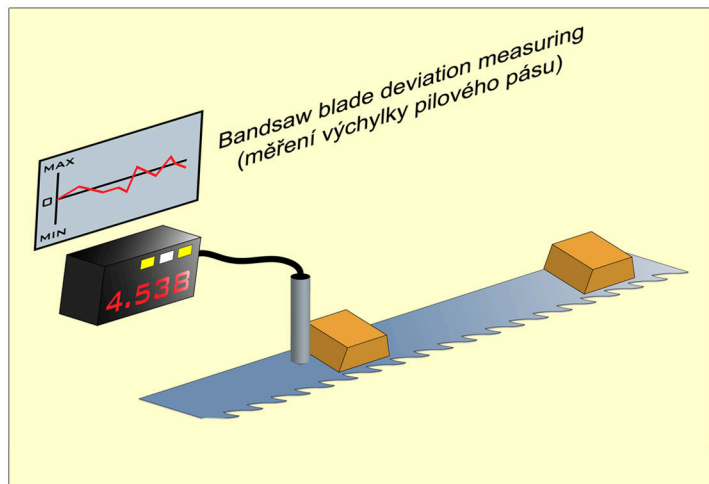

The Ogden collaboration



Since the late 1990s, Neva Trade and Ogden have worked cooperatively to share knowledge and resources in the field of thin-cutting technology. Through the strength of our ongoing relationship, our two companies have successfully taken this technology to the next level. Neva Trade and Ogden have combined their vast engineering and manufacturing resources to build the REMAX 500 CNC jointly from their facilities in the Czech Republic and the United States.